

## Turning on the Electric Power Brush

The Electric Power Brush can only be turned on if the canister is also turned on (Canister on/off button is located on the canister body).

The power brush on/off button is located on the left side of the nozzle



You can set the airflow by using the airflow-setting button on the right side of the power brush

## Removing the Brush Roll

The Brush Roll may need to be removed at times to cut threads or human hair that have become tangled around the Brush Roll. Unplug the vacuum and remove the wand from the power nozzle. Turn the electric power brush over and remove the 4 screws to lift off the brush cover. Then again, turn back the power brush, take off the belt, and pull the brush roll out.

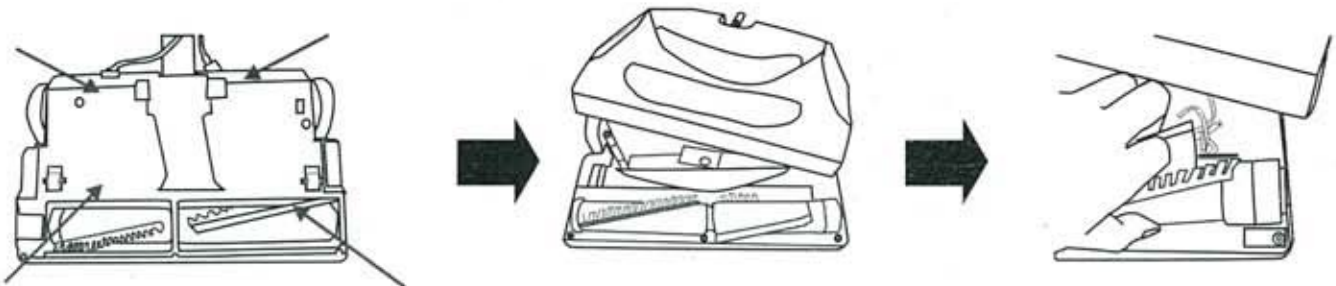

## Reinserting the Brush Roll

Reinsert the brush roll back into the brush roll tray (make sure the belt is attached properly) with the rounded edge of the end cap facing down. Place the brush cover back onto the brush and replace the 4 screws.

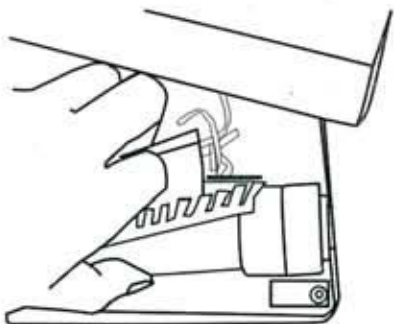

## Power Brush Assembly

1. Slide the metal tube into the power nozzle aligning the holes until it clicks into place

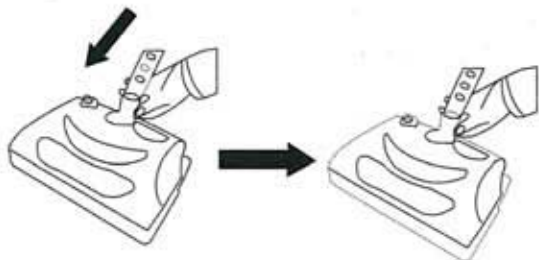

2. Plug the cord into the handle

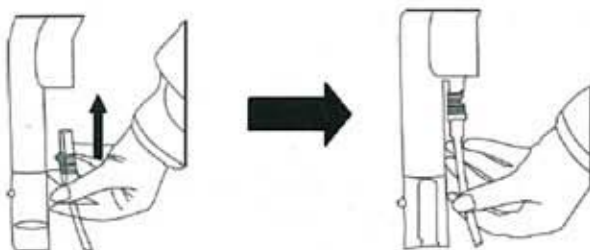

3. Tie up the cord to the telescopic tube with the provided bands

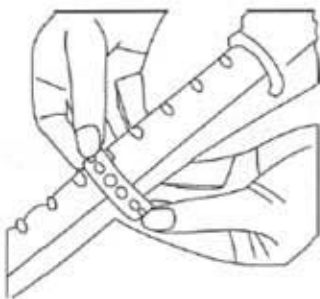

4. Snap the hose into the canister



5. Feed the cord from the hose underneath the canister to the air intake duct and plug directly into the main body.

